

3I370DW

3.5" Plus SBC supports 8th / 9th Gen Intel® Coffee Lake-S, i9 / i7 / i5 / i3 & Pentium / Celeron (35W) CPU, Intel® Q370 chipset DP, HDMI, eDP, 5 x Intel Gb Ethernet, 8 x USB 8DI / 8DO, 4 x COM, 1 x Mini PCIe, 1 x M.2, 1 x PCIe, 1 x SIM, SMBus

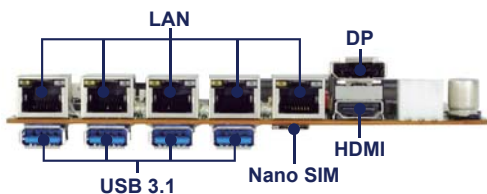
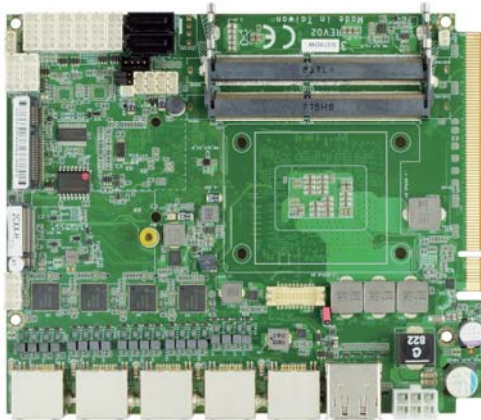

Features:

- 8th / 9th Gen Intel® Coffee Lake-S, i9 / i7 / i5 / i3 / Pentium / Celeron (35W) CPU
- Intel® Q370 chipset
- 2 x DDR4 SODIMM socket, Max. 64GB
- Multiple Independent display: DP, HDIM & eDP (eDP to VGA and DVI converter)
- 5 x Intel GbE LAN, 4 x USB 3.1, 4 x USB 2.0
- 4 x COM, 1 x Mini PCIe, 1 x PCIe, 1 x M.2, 1 x Nano SIM
- 8DI / 8DO, TPM 2.0, SMBus

Dimensions: (Unit:mm)

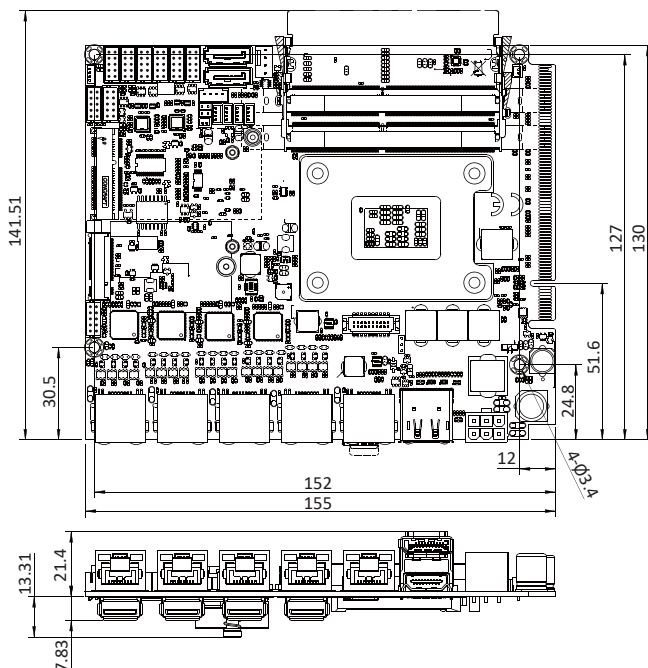

Specifications :

- CPU
8th / 9th Gen Intel® Coffee Lake-S, i9 / i7 / i5 / i3 / Pentium / Celeron (35W) CPU
- MB Chipset
Intel® Q370
- Graphics
Intel® UHD Graphics, Support DirectX 12 & OpenGL 4.5
- System Memory
2 x DDR4 2400 MHz SODIMM, Max. 64GB
- Storage
2 x SATA ports 3.0 Data transfer rates up to 6.0 Gb/s (600 MB/s)
1 x mini card socket for mSATA
1 x M.2 B Key, Type 3042 (Support NVME)
- BIOS
AMI UEFI BIOS
- Display
1 x DP, 1 x HDMI, eDP (eDP to VGA and DVI converter)
- TPM
TPM 2.0
- LAN
1 x Intel GbE I219LM (external), 4 x Intel 2.5 GbE I225-V (external)
- Audio (OEM)
High Definition Audio Specification, Support Line-out / Mic-in / Line-in
- Expansion Interface
1 x Full size Mini PCIe (PCIe / mSATA / USB 3.0 / USB2.0)
1 x M.2 B Key, Type 3042 (mSATA / PCIe x 2 / USB 3.0 / USB 2.0), 1 x Nano SIM
1 x PCIe 16x / 8x / 4x / 1 x golden finger

Expansion Options

- CN064 M.2 B key 2242 to M.2 E Key 2230, WiFi 6 + BT
- CN067 M.2 B key 2242 to M.2 B Key 2252, 4G / 5G (3.7V by BOM Control)
- CN059 USB to Line-out / Mic-in
- CC007 USB to 4 port COM
- CIO116G SMBus to 8DI + 8DO
- PW351 1 port PoE PSE
- PW352 2 port PoE PSE
- PW301 802.3AF / AT PD module
- PW205 Wide Range power board (9~36V) with power Ignition on/off delay
- PW206 12V / 24V DC to DC Redundant Power Board
- DP001 eDP to VGA
- eDP003 eDP to DVI
- eDP004 eDP to HDMI
- eDP001 eDP to LVDS (OEM)

- USB
4 x USB 3.1, Gen1 (external) ; 4 x USB 2.0 (internal)
- Serial IO
4 x RS232 / 422 / 485 (internal) (OEM option to 6 x COM w/o DIO)
*COM1, COM2 pin9 5V / 12V (Option)
- GPIO
Hardware digital Input & Output, 8 x DI / 8 x DO
- SMBus
1 x SMBus
- WDT
Hardware Watch Dog Timer, 0~255 sec programmable
- Power Input
Wide Range +12~36V
- Dimension
130 x 155 mm
141.51 x 155 mm (Memory at Horizontal DIMM Socket) ; Weight: 192g
- Operation Temperature (100 % CPU Usage)
-20°C~60°C (Core i7 8700T)
- Operation Humidity
5~95%, non-condensing
- Chassis (OEM I/O Expansion by request)
Box PC: Apollo-S, Apollo-RS
- OS Support
Windows® 10 IOT ; Windows® 11 IOT
Ubuntu 22.04 above, Fedora 36 above